



愛高實業(香港)有限公司
HICO INDUSTRIAL (HK) LIMITED

Product Specifications

Poker LCD Game

Product Code	HCS-G023-0
Version	1.0
Date	April 29, 2002

Hong Kong 香港

22nd Floor, Delta House, 3 On Yiu Street, Siu Lek Yuen, Shatin, N.T., Hong Kong
香港新界沙田小瀝源安耀街三號匯達大廈二十二樓
Tel: 26486862 Fax: 26373691 Email: enquiry@hico.com.hk

Shenzhen 深圳

Rm. 1605, 16/F., Times Plaza, 1 Prince Road, Shekou, Shenzhen, China
深圳蛇口太子路一號新時代廣場十六樓一六零五室
Tel: (0755) 6812638 Fax: (0755) 6817308 Email: sales@sz.hico.com.hk

Shanghai 上海

Level 21, HSBC Tower, 101 Yin Cheng East Road, Pudong, Shanghai, China 200120
上海市浦東新區銀城東路 101 號匯豐大廈二十一樓, 郵編: 200120
Tel: (021) 28903020 Fax: (021) 28903022 Email: sales@sh.hico.com.hk

Room 833, No. 8 Huajing Road, Waigaoqiao Free Trade Zone, Pudong, Shanghai, China 200131
上海市浦東外高橋保稅區華京路八號八三三室, 郵編: 200131
Tel: (021) 50462088 Fax: (021) 50460960



愛高實業(香港)有限公司 HICO INDUSTRIAL (HK) LIMITED

22/F., DELTA HOUSE, 3 ON YIU STREET, SIU LEK YUEN, SHATIN, N.T., HONG KONG.
TEL: (852) 2648 6862 FAX: (852) 2637 3691 URL: <http://www.hico.com.hk> EMAIL: enquiry@hico.com.hk
香港新界沙田小瀝源安耀街三號匯達大廈二十二樓

Poker (HCS-G023-0)

Project Title: POKER LCD Game
Project Code: HCS-G023-0
MCU: TM8713
Date: Apr 22, 2002

GENERAL DESCRIPTION:

The model is implemented by a 4-bit single chip micro-controller into a LCD Poker Card Game.

FEATURES:

- Operating voltage: 1.5V
- 8 buttons' operation:
 - ON / DEAL
 - SOUND
 - HAND / SCORE
 - HOLD CARD 1 TO 5
- Built-in LCD driver directly drive 1/3 bias 1/4 duty 3 V LCD.
- Auto-off in about 1 minute if there is no key activity.
- Initial score: 400
- Max Score: 9999
- Sound effects:
 - Keytone
 - Melody for Losing
 - Melody for Winning

LCD PATTERN:

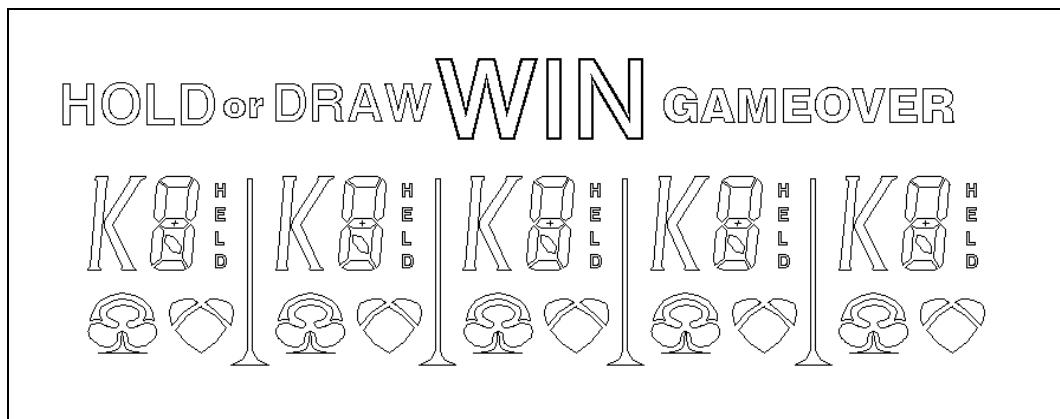



愛高實業(香港)有限公司
HICO INDUSTRIAL (HK) LIMITED

22/F., DELTA HOUSE, 3 ON YIU STREET, SIU LEK YUEN, SHATIN, N.T., HONG KONG.
 TEL: (852) 2648 6862 FAX: (852) 2637 3691 URL: <http://www.hico.com.hk> EMAIL: enquiry@hico.com.hk
 香港新界沙田小瀝源安耀街三號匯達大廈二十二樓

Poker (HCS-G023-0)

KEY DESCRIPTIONS:

BUTTON	FUNCTION
ON / DEAL	<ul style="list-style-type: none"> ▪ Turn on the game while in off mode. ▪ Start game in game over mode. ▪ Score will be reset to 400 if it is below 5. ▪ Deal card when HOLD or DRAW is flashing.
SOUND	<ul style="list-style-type: none"> ▪ Press to toggle the game sound on or off.
HAND / SCORE	<ul style="list-style-type: none"> ▪ Show the last hand of cards in game over mode. ▪ Show the current score in game over mode.
HOLD CARD 1	<ul style="list-style-type: none"> ▪ Toggle to Hold the leftmost card when Hold or Draw is flashing.
HOLD CARD 2	<ul style="list-style-type: none"> ▪ Toggle to Hold the 2nd card from the left when Hold or Draw is flashing.
HOLD CARD 3	<ul style="list-style-type: none"> ▪ Toggle to Hold the 3rd card from the left when Hold or Draw is flashing.
HOLD CARD 4	<ul style="list-style-type: none"> ▪ Toggle to Hold the 4th card from the left when Hold or Draw is flashing.
HOLD CARD 5	<ul style="list-style-type: none"> ▪ Toggle to Hold the 5th card from the left (rightmost card) when Hold or Draw is flashing.

OPERATING INSTRUCTIONS:

1. Upon power up (or reset), 400 points will be given to player. GAME OVER indicator will be flashing to indicate standby for a new game.
2. Press ON / DEAL to get the first 5 cards. 5 points will be deducted as for the bet amount. After 5 cards dealt, HOLD or DRAW will be flashing. Player can use HOLD CARD 1 to 5 to retain the desire cards. Press ON / DEAL again to change the unwanted cards. Player has one chance to make alterations. After all cards dealt, the result will be computed according to the scoring scheme below.



愛高實業(香港)有限公司
HICO INDUSTRIAL (HK) LIMITED

22/F., DELTA HOUSE, 3 ON YIU STREET, SIU LEK YUEN, SHATIN, N.T., HONG KONG.
TEL: (852) 2648 6862 FAX: (852) 2637 3691 URL: <http://www.hico.com.hk> EMAIL: enquiry@hico.com.hk
香港新界沙田小瀝源安耀街三號匯達大廈二十二樓

Poker (HCS-G023-0)

SCORING SCHEME:

1. Pair (jacks or better)	5
2. Two pairs	10
3. Three of kind	15
4. Straight	20
5. Flush	25
6. Full house	40
7. Four of a kind	125
8. Straight flush	250
9. Royal flush	2000

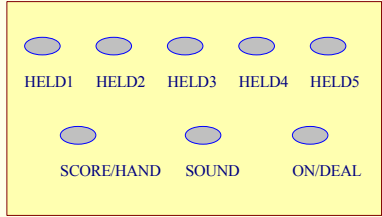
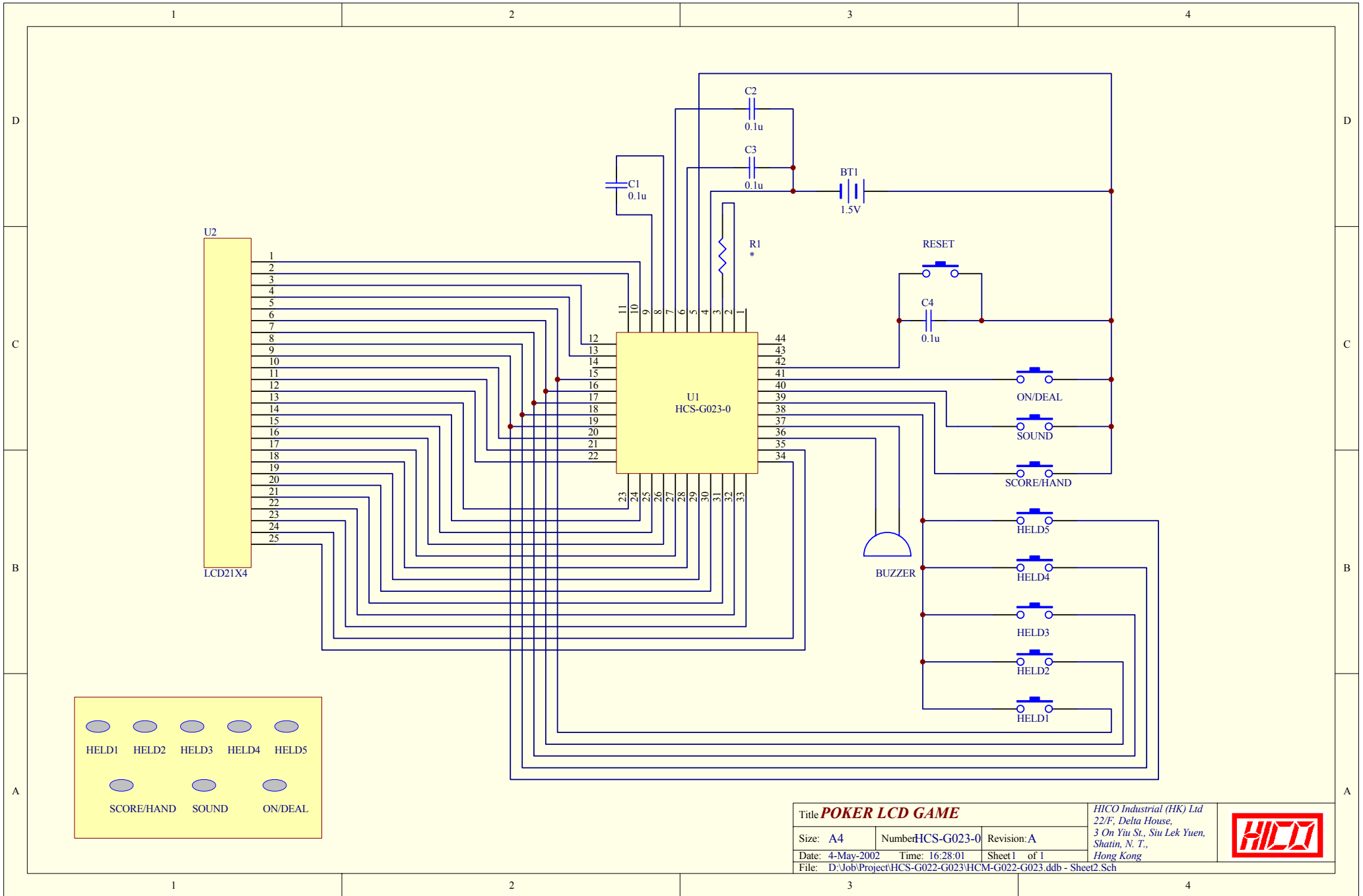

Title POKER LCD GAME			HICO Industrial (HK) Ltd 22/F, Delta House, 3 On Yiu St., Siu Lek Yuen, Shatin, N. T., Hong Kong	
Size: A4	Number: HCS-G023-0	Revision: A		
Date: 4-May-2002	Time: 16:28:01	Sheet 1 of 1		
File: D:\Job\Project\HCS-G022-G023\HCM-G022-G023.ddb - Sheet2.Sch				

VER NO.	DISPLAY TYPE	DRIVE CONDITION	DISPLAY MODE	OPERATION TEMPERATURE	STORAGE TEMPERATURE	OPERATION VOLTAGE	VIEWING DIRECTION	REMARK
00	TN GLASS	1/4 DUTY 1/3 BIAS	REFLECTIVE POSITIVE	0°C TO +50°C	-10°C TO +60°C	4.5 V	6 : 00	POL: F1225DU/F3225M
01								POL: F1225DU/AGN-1045MP

HICO IND'L (HK) LTD.

Description	General Specification		
Model no.	GH10029E		
DWG no.	5698	Rev.no.	A01
Scale		Unit	mm
Page	1	of	6
Date	09-05-2002		
Drawn by	B-CUI		
Checked by			

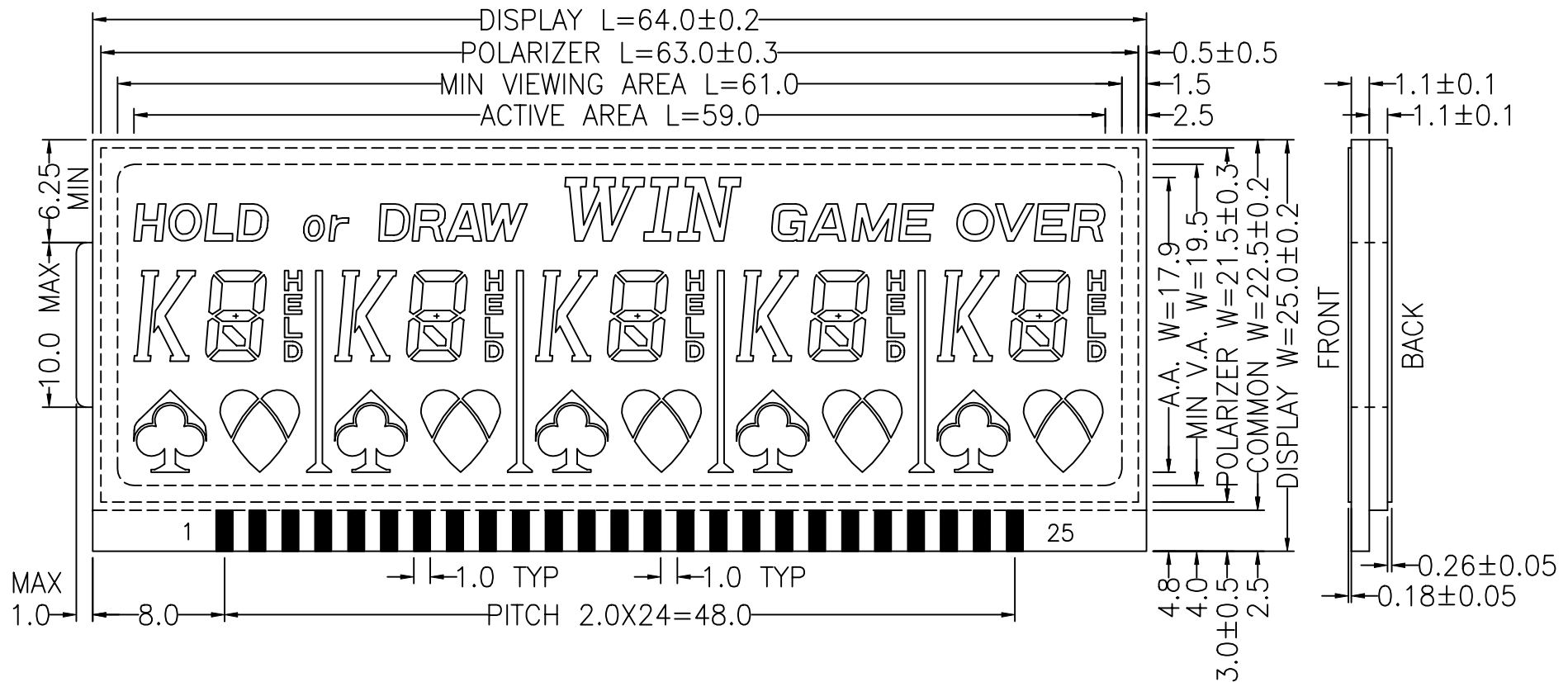
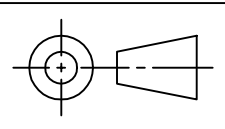

(1 : 1)

HICO IND'L (HK) LTD.			
Description	LCD ARTWORK(1)		
Model no.	GH10029E		
DWG no.	5698	Rev.no.	A01
Scale	2.5 : 1	Unit	mm
Page	2	of	6
Date	09-05-2002		
Drawn by	B-CUI		
Checked by			

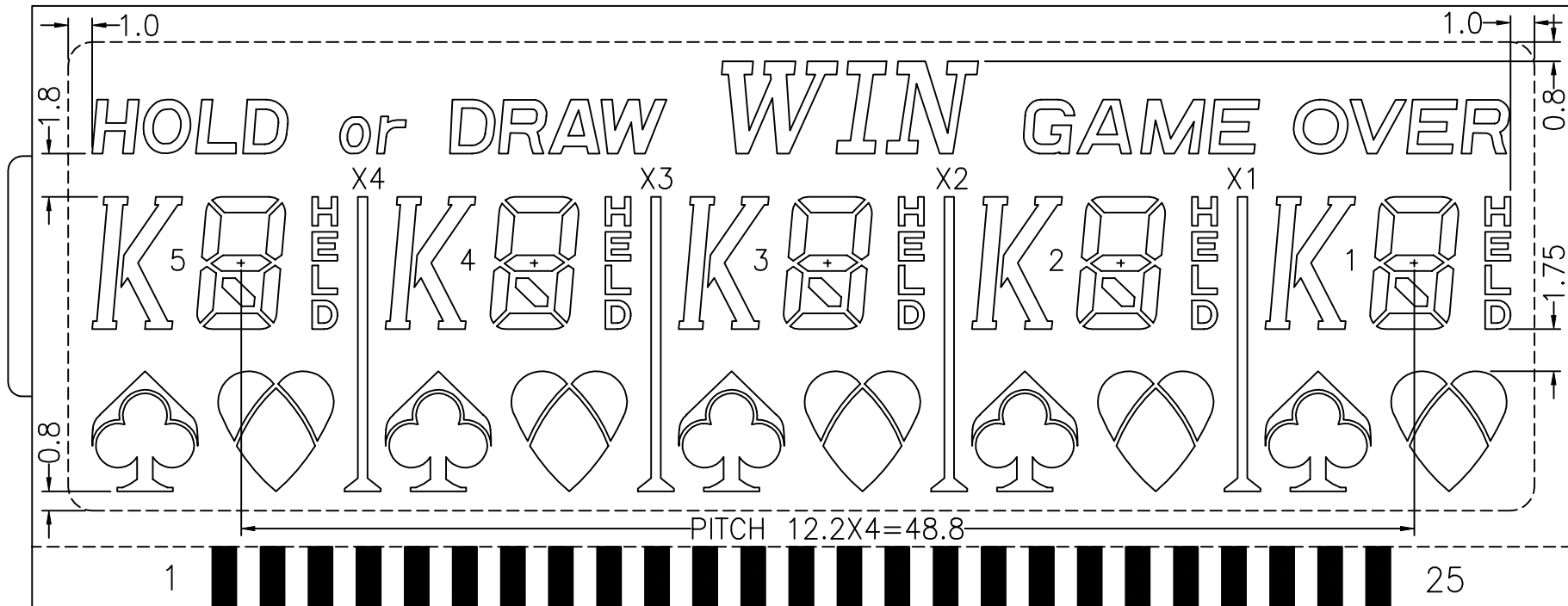
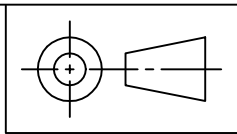

HICO IND'L (HK) LTD.			
Description	Labelling		
Model no.	GH10029E		
DWG no.	5698	Rev.no.	A01
Scale	3.5 : 1	Unit	mm
Page	3	of	6
Date	09-05-2002		
Drawn by	B-CUI		
Checked by			

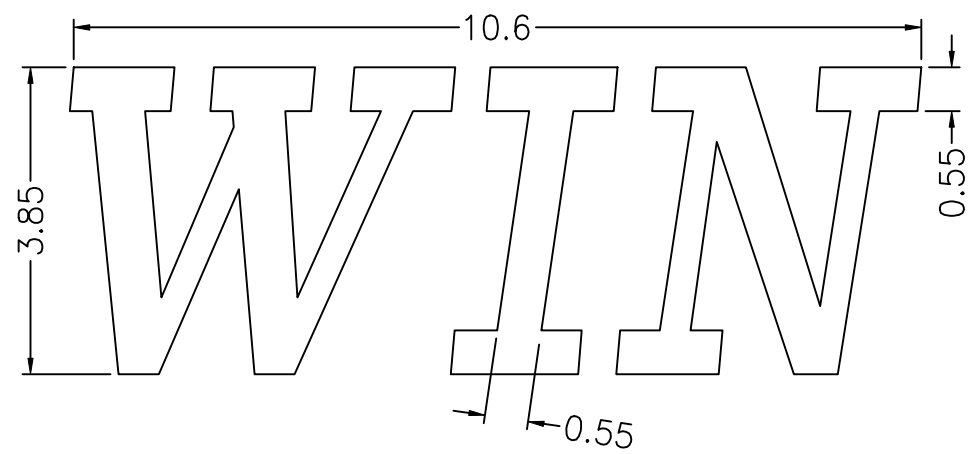
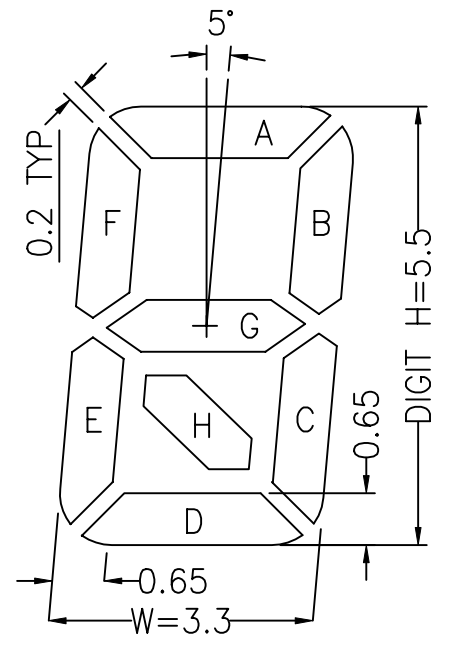
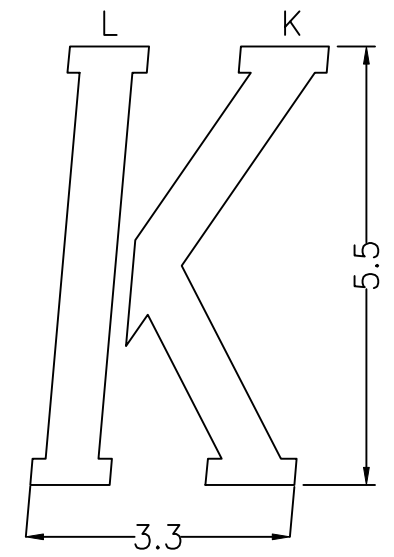
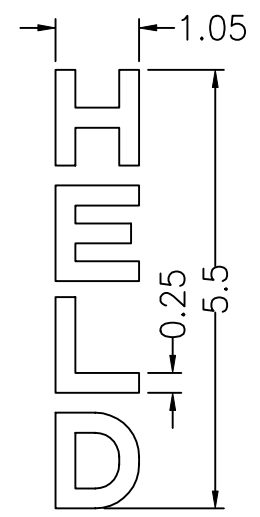
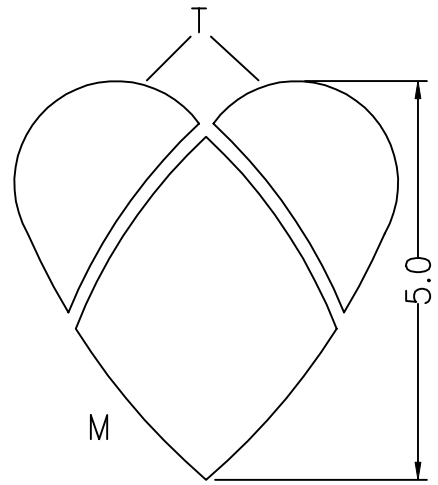
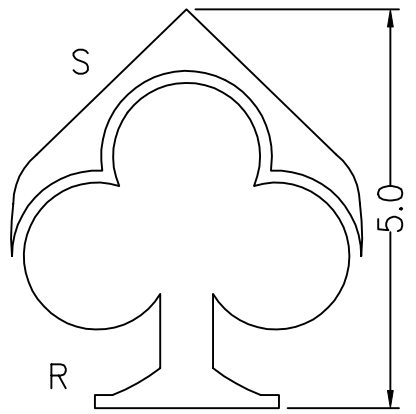
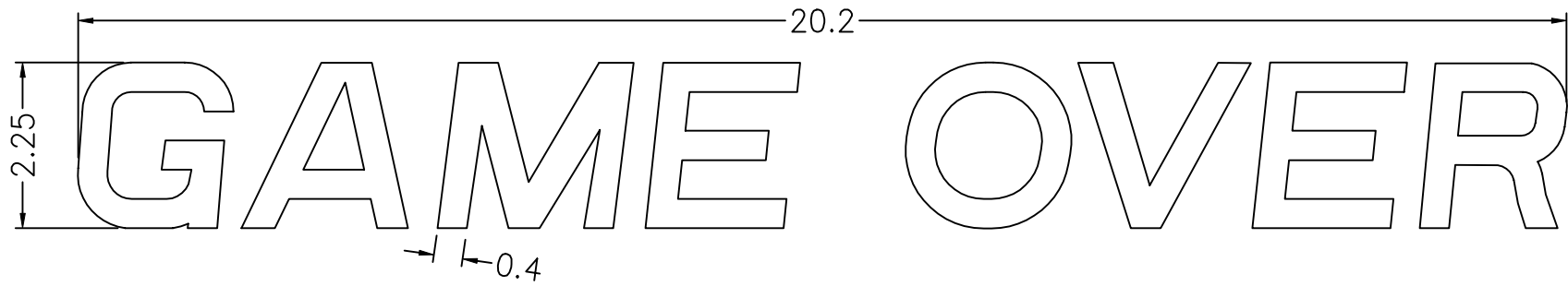
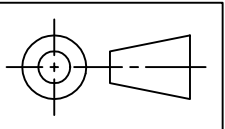

HICO IND'L (HK) LTD.			
Description	Graphic Dimension		
Model no.	GH10029E		
DWG no.	5698	Rev.no.	A01
Scale	10 : 1	Unit	mm
Page	4	of	6
Date	09-05-2002		
Drawn by	B-CUI		
Checked by			

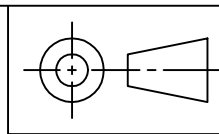

<u>PAD NO.</u>	<u>IC NO.</u>	<u>COM1</u>	<u>COM2</u>	<u>COM3</u>	<u>COM4</u>
1	COM1	COM1	--	--	--
2	COM2	--	COM2	--	--
3	COM3	--	--	COM3	--
4	COM4	--	--	--	COM4
5	SEG1	DRAW	HOLD	5L	5S
6	SEG2	WIN	or	5K	5R
7	SEG3	5F	5E	5D	5M
8	SEG4	5A	5G	5H	5T
9	SEG5	5HELD	5B	5C	X4
10	SEG6	4L	4K	4S	4R
11	SEG7	4F	4E	4D	4M
12	SEG8	4A	4G	4H	4T
13	SEG9	4HELD	4B	4C	X3
14	SEG10	3L	3K	3S	3R
15	SEG11	3F	3E	3D	3M
16	SEG12	3A	3G	3H	3T
17	SEG21	3HELD	3B	3C	X2
18	SEG22	2L	2K	2S	2R
19	SEG23	2F	2E	2D	2M
20	SEG24	2A	2G	2H	2T
21	SEG25	2HELD	2B	2C	X1
22	SEG26	1L	1K	1S	1R
23	SEG27	1F	1E	1D	1M
24	SEG28	1A	1G	1H	1T
25	SEG29	GAME OVER	1B	1C	1HELD

HICO IND'L (HK) LTD.

Description	Pad Configuration		
Model no.	GH10029E		
DWG no.	5698	Rev.no.	A01
Scale		Unit	mm
Page	5	of	6
Date	09-05-2002		
Drawn by	B-CUI		
Checked by			

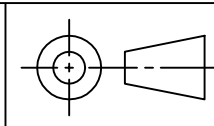

HOLD or DRAW WIN GAME OVER

K8 HELD | K8 HELD | K8 HELD | K8 HELD | K8 HELD



1



25

HICO IND'L (HK) LTD.

Description	LCD ARTWORK(2)		
Model no.	GH10029E		
DWG no.	5698	Rev.no.	A01
Scale	3.5 : 1	Unit	mm
Page	6	of	6
Date	09-05-2002		
Drawn by	B-CUI		
Checked by			